

SIDES Metres		ANGLES OF DIRECTION		CO-ORDINATES Y System: WG 29° X		S.G. No.
		Constants:		0, 00	+2800 000, 00	177/2003
AB	77,55	215 14 30	A	+86 996,73	+79 786,27	Approved
BC	118,95	315 18 10	B	+86 951,98	+79 722,93	<i>LB</i>
CD	76,36	45 18 10	C	+86 868,32	+79 807,48	
DA	105,40	135 18 10	D	+86 922,60	+79 861,19	for
Servitude		Data				SURVEYOR- GENERAL
EA	7,24	135 18 10	E	+86 991,63	+79 791,41	2003-01-29
AB	77,55	215 14 30	A	+86 996,73	+79 786,27	ORD. 20/1986
BF	7,24	315 18 10	B	+86 951,98	+79 722,93	SECT. 18
FE	77,55	35 14 30	F	+86 946,89	+79 728,08	PLAN AND CERTIFICATE
Pre 10		186	△	+89 368,85	+78 787,69	
Pre 11		187	△	+86 571,88	+82 222,45	

Description of Beacons

- A : 20mm iron pipe
- B, C, D : Iron standard
- E, F : 12mm iron peg

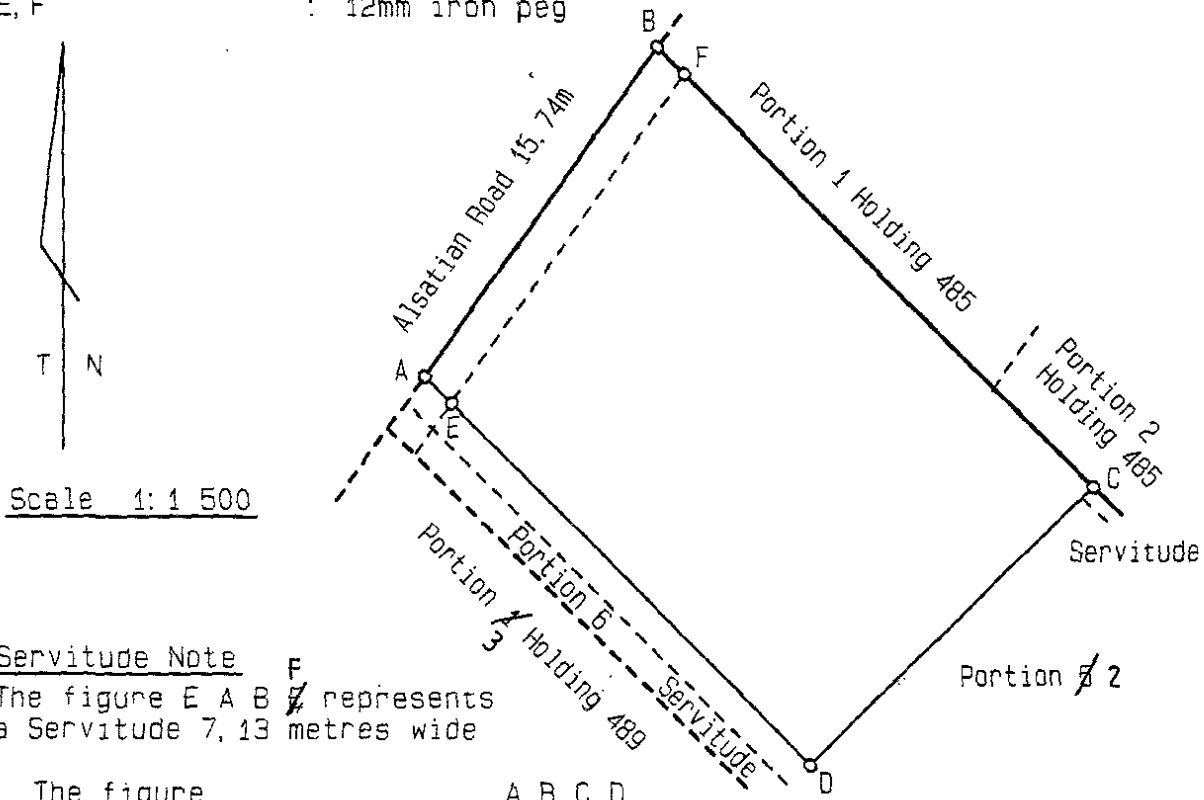

Servitude Note

The figure E A B F represents a Servitude 7,13 metres wide

The figure A B C D represents 8 565 Square metres of land being Portion 1 (a portion of Portion 3) of Holding 489 621

GLEN AUSTIN AGRICULTURAL HOLDINGS EXTENSION 3 TOWNSHIP

Province of Gauteng
 Surveyed in October 2001
 and November 2002

by me *[Signature]*
 P R Barnard PLS - 0025
 Professional Land Surveyor

This diagram is annexed to No. T79287/2005 d.d. i.f.o. Registrar of Deeds	The original diagram is S.G. No. 176/2003 Transfer Grant	File Holdings S.R. 72/2003 G.P.S.G.No. A1305/1956 Comp. IRNA-21 TP : 391
---	--	--

LB
LB
LB
LB