

SU 34F50

S.L.C.
vol. 34,
fo. 50 -
S.P.D. -

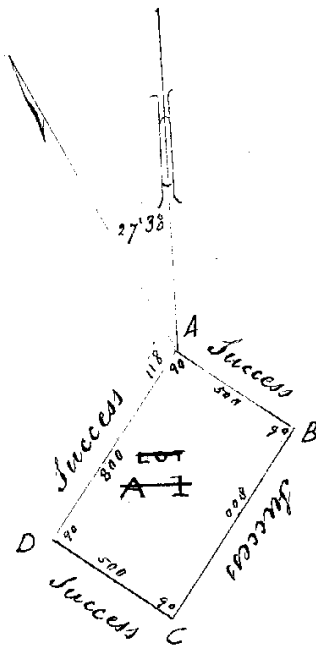

ESTABLISHED		Ref No. S.R. No.
Beacons	Boundary	
A.B.	A-B, B-C,	36/1974
C.D.	C-D, D-A	306/1974

BEACONS A.B.C.D.	VIDE S.R. NO.
REPLACED/RELOCATED	306/1974

Reg. Div.
E

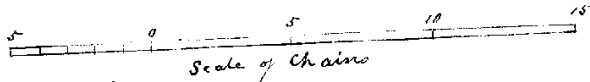

~~Now known as~~
~~Sub A' of the farm Success N° 1113~~

EN
1/10/51

The above diagram marked Lot A I represents 4 acres of land situate in, and being a portion of, the farm "Success" in the County of Umhlathe, Colony of Natal: bounded on all sides by the said farm "Success" surveyed by me

October 1870.

George Holgate
Sole Surveyor

NOW SUB. 2	OF THE
FARM SUCCESS	NO 1113

6064

FTNM