

WALL, MARRIOTT, PAUL & BORGES, SUB-DIVISIONAL DIAGRAM  
LAND SURVEYORS.

SIDES METRES	DIRECTIONS	CO-ORDINATES		S.G. No.:
		Y	SYSTEM	
	Constant			3234/1973
			+60 000,00	Approved
			+3 420 000,00	<i>H. P. Beattie</i>
AB	51,17	326 43 40	A + 9 532,90	+ 7 611,56
BC	23,73	49 51 40	B + 9 504,82	+ 7 654,34
CD	56,65	146 43 40	C + 9 522,96	+ 7 669,64
DA	23,70	243 07 30	D + 9 554,04	+ 7 622,28

PTB  
PDR 10587

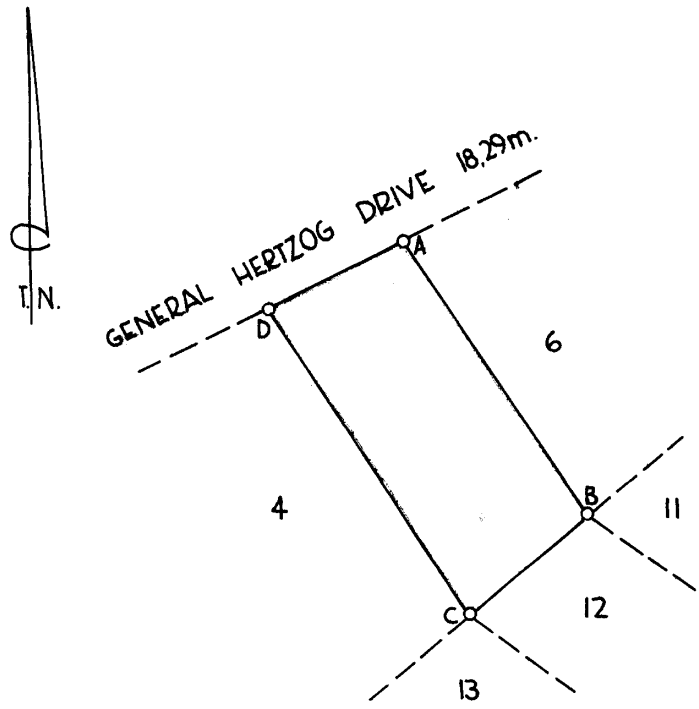

BEACON DESCRIPTION  
12mm pipes: A,B,C,D.

Scale: 1:1000

The figure A.B.C.D. represents 1270 square metres of land being SUB 5 OF LOT 833 PALM BEACH situate in the County of Alfred, Province of Natal. Surveyed in September, November 1972 and May 1973. by me *[Signature]* Land Surveyor

This diagram is annexed to	The Original Diagram is S.G.	File No. 11
No. T9773/1976	No. 3816/1968	S.R. No. 1075/1973
Registrar of Deeds	Transfer No. 12368/1969	Comp. ET.TD.16C
		Degree Sheet 68

